



Diner's spectacular view

**The Melvaig Partnership Ltd SC505495** is a Company formed by a few loyal ex-customers of the Melvaig Inn who realised what a fantastic amenity the Inn had been for the past eight years for the local residents and holidaymakers alike and how sorely it would be missed!

The plan is to build a new licensed eatery, to open for the 2016 season , which will be fully commercial in summer and provide a community hub in winter. It is intended that the building will be of timber with large windows to maximise on the view and summer sunsets.



## Investment Potential

Although it's early days, we already have over half of the investment capital the project requires.

**However, more is needed!**

Each share costs £1,000 so if you can find a bit of spare cash to invest in this exciting initiative we would love to hear from you.

Please request a copy of the business plan or have a chat with any of the steering group.

[Contact@newmelvaiginn.co.uk](mailto:Contact@newmelvaiginn.co.uk)

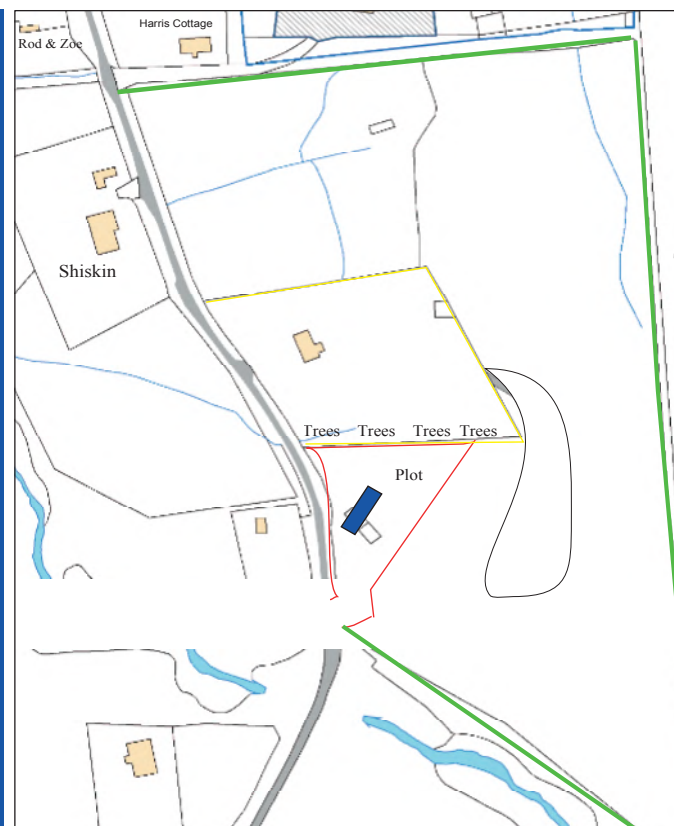

Plot at the entrance to the village coming from Gairloch

Highland Council Planning has been consulted and has given advice on the project which has now gone to an architect. The next stage is to secure more investment before instructing the architect to complete drawings and submit a formal planning application.

The building will not be big - 12m X 6m and offering seating for 24. A licence to serve alcohol will be applied for and we are even hoping to fit the pool table in! The idea is to make it cosy and warm with good insulation in the fabric of the build and a high spec wood burning stove to supply heating. And, above all, to serve good food!

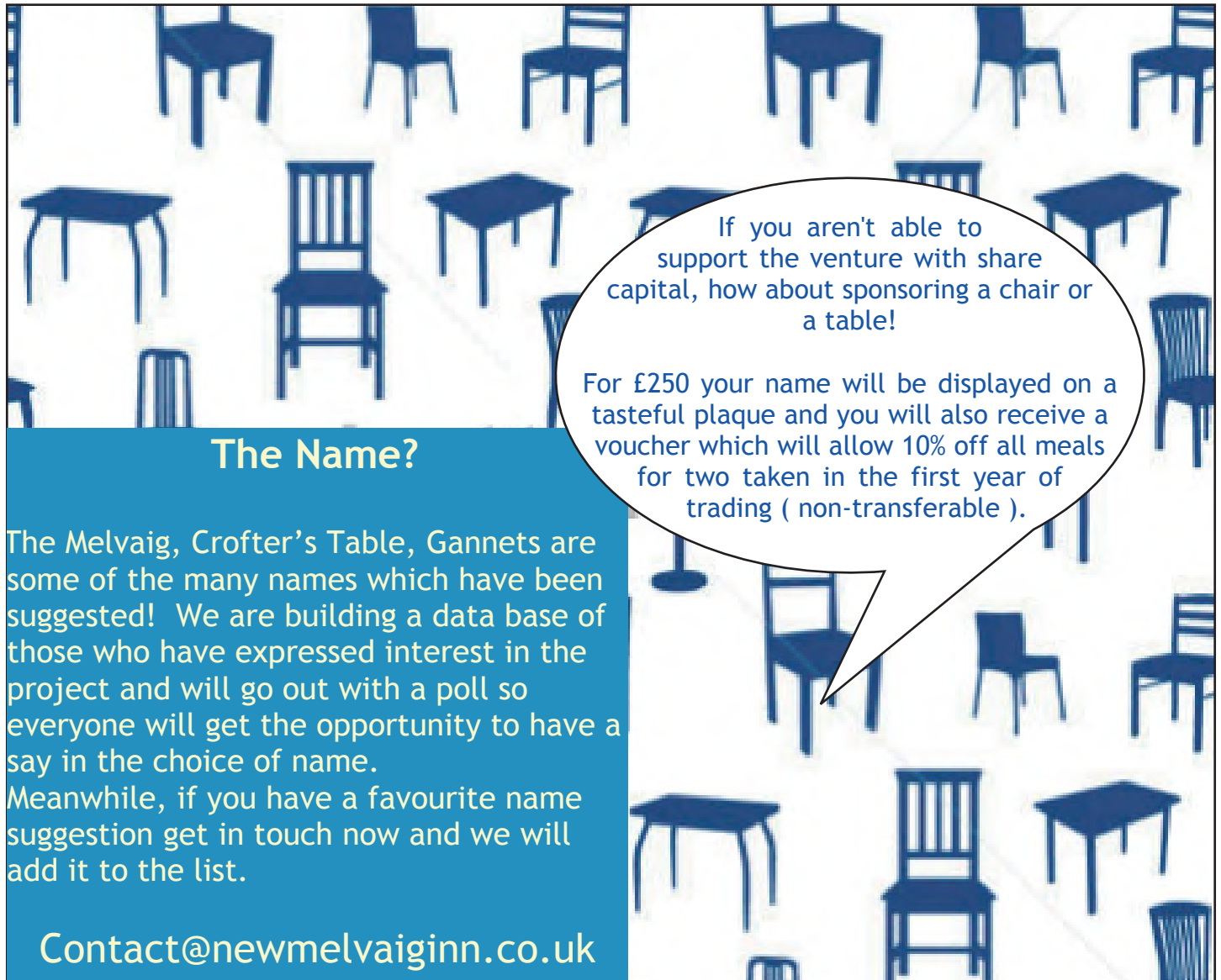

**The Name?**

The Melvaig, Crofter's Table, Gannets are some of the many names which have been suggested! We are building a data base of those who have expressed interest in the project and will go out with a poll so everyone will get the opportunity to have a say in the choice of name. Meanwhile, if you have a favourite name suggestion get in touch now and we will add it to the list.

Contact@newmelvaiginn.co.uk

If you aren't able to support the venture with share capital, how about sponsoring a chair or a table!

For £250 your name will be displayed on a tasteful plaque and you will also receive a voucher which will allow 10% off all meals for two taken in the first year of trading ( non-transferable ).

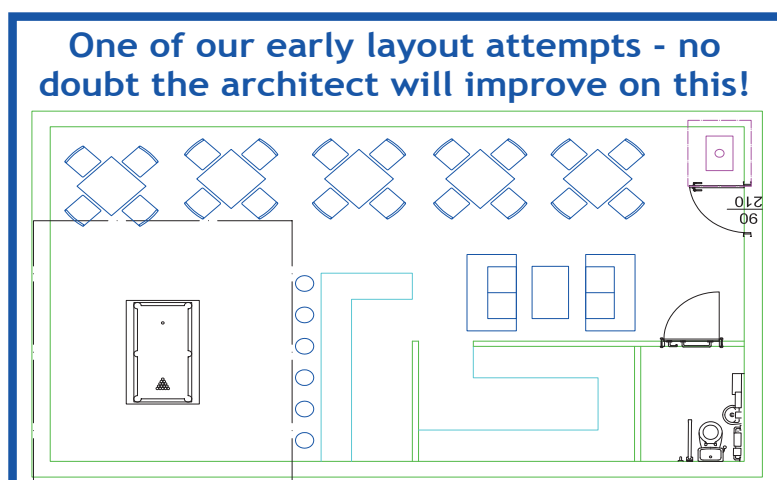

**The Melvaig Partnership**  
Steering Group - *contact any of us for a chat about the project!*

**John Dyke** 01445 771256  
john.dyke@s2dd.co.uk

**Pat Gulliver** 01445 771248  
patricia.gulliver1@btinternet.com

**Fran Cree** 01445 771320  
Info@fionncroft.co.uk

**Peter Diegeler** 01445 771246  
peter@rsvp.co.uk

**Elsbeth Urquhart** 01445 771207  
elizabeth.urquhart@btopenworld.com